

Type No. \_\_\_\_\_

Catalog No. \_\_\_\_\_

Job. Name \_\_\_\_\_

# ProTector™ V Series

## 2-Foot Linear Fluorescent Vandal-Resistant Lighting Fixture

### APPLICATIONS

- Ideal for high-traffic areas requiring architectural surface-mounted luminaires that withstand intentional vandalism

### CONSTRUCTION

- Marine-grade, extruded aluminum housing
- Tamper-resistant stainless steel hardware
- Architectural die-cast end caps
- Polyester powder, semi-gloss textured finish
- Fade-resistant color (custom colors available – consult factory)
- Standard color is white

### ELECTRICAL

- High-Efficiency T5, T5HO and T8 lamping
- Exceptionally high fixture efficiency
- Instant-on

### OPTICS

- 2', 4' and 8' sizes in T5, T5HO or T8 configurations
- Extruded impact-resistant polycarbonate lens
- Delivers uniform illumination without glare
- Available in clear prismatic and opal prismatic

### MOUNTING

- No field drilling required
- Conduit-ready knock-outs in end caps

### WARRANTY/LISTINGS

- “LifeLyte” limited lifetime warranty
- UL/CUL listed for wet locations

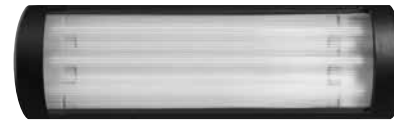

11" Wide Model



7" Narrow Model

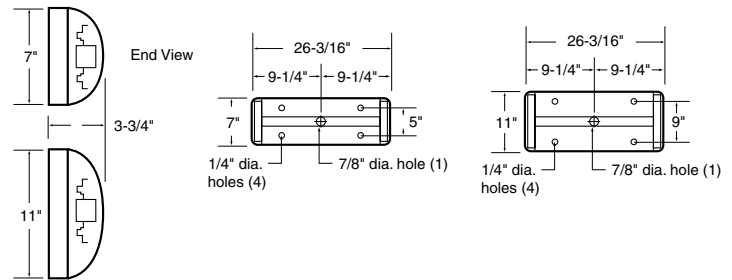

### BALLAST MATRIX

# Lamps	Wattage	Source	Ballast
2	14w	T5	N2Y
	17w	T8	K2Y
	24w	T5HO	S2Y
3	14w	T5	N6Y
	17w	T8	K3Y
	24w	T5HO	S6Y
4	14w	T5	N8Y
	17w	T8	K4Y
	24w	T5HO	S8Y



### Ordering Guide Example: PVNO224BS2YB

P	VN	O	2	24	1	S2Y	B	F
Series	Style	Lens	Lamp #	Watts	Volts	Ballast	Color*	Options

P=ProTector Linear

VN=Narrow (7")  
VW=Wide (11")

O=Opal Poly  
C=Clear Poly

2 (7" Narrow)  
3 (11" Wide)  
4 (11" Wide)

14 (T5)  
17 (T8)  
24 (T5HO)

1=120v  
4=277v  
B=Univ

See Ballast Matrix Above

B=Black  
W=White  
P=Bronze

F=Fused

\* Custom colors available. Consult factory.



2345 Vauxhall Road - P.O. Box 129  
Union, NJ 07083  
800-334-2212

www.exceline.com - www.protectorseries.com

ExcelLine is a Philips group brand

Product information is subject to change without notice

