

Type No. _____

Catalog No. _____

Job. Name _____

ProTector™ L Series

4-Foot Linear Fluorescent Vandal-Resistant Lighting Fixture

APPLICATIONS

- Ideal for high-traffic areas requiring architectural surface-mounted luminaires that withstand intentional vandalism

CONSTRUCTION

- Marine-grade, extruded aluminum housing
- Tamper-resistant stainless steel hardware
- Architectural die-cast end caps
- Polyester powder, semi-gloss textured finish
- Fade-resistant color (custom colors available – consult factory)
- Standard color is white



ELECTRICAL

- High-Efficiency T5, T5HO and T8 lamping
- Exceptionally high fixture efficiency
- Instant-on

OPTICS

- 2', 4' and 8' sizes in T5, T5HO or T8 configurations
- .156" thick extruded impact-resistant polycarbonate lens
- Delivers uniform illumination without glare
- Available in clear prismatic and opal prismatic

MOUNTING

- No field drilling required

WARRANTY/LISTINGS

- "LifeLyte" limited lifetime warranty
- UL/CUL listed for wet locations

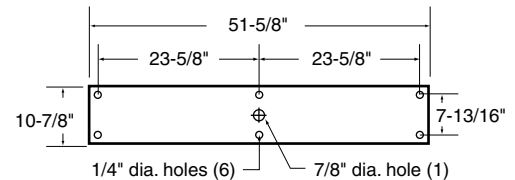
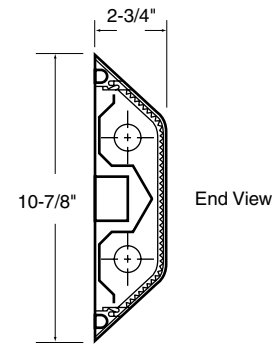

Ordering Guide Example: PLO2541S2YB

P	L	O	2	54	1	S2Y	B	
Series	Style	Lens	Lamp #	Watts	Volts	Ballast	Color*	Options
P=ProTector Linear	L=Wide	O=Opal Poly C=Clear Poly	2	28 (T5) 32 (T8) 54 (T5HO)	1=120v 4=277v B=Univ	N2Y (T5) K2Y (T8) S2Y (T5HO)	B=Black W=White P=Bronze	F=Fused RB=Row Beginning RM=Row Middle RE=Row End Battery Back-Up Consult Factory for Availability

* Additional colors available. Consult factory.

Row Mounting:

Factory engineered to speed row mounting applications. When ordering, make note that all row mounting options require 1 **RB** and 1 **RE** style to begin and end the run. 1 or multiple **RM** styles can be used. For shorter runs, an **RB** will mount to an **RE** style unit.



2345 Vauxhall Road - P.O. Box 129
Union, NJ 07083
800-334-2212
www.exceline.com - www.protectorseries.com

ExcelLine is a Philips group brand

Product information is subject to change without notice

